

BLUE LAKE TOWNHOMES

A REPLAT OF ALL OF BLUE LAKE RESIDENTIAL, RECORDED IN PLAT BOOK 109,
 PAGES 135 THROUGH 144, OF THE PUBLIC RECORDS OF PALM BEACH COUNTY, FLORIDA
 LYING IN SECTION 12, TOWNSHIP 47 SOUTH, RANGE 42 EAST
 CITY OF BOCA RATON, PALM BEACH COUNTY, FLORIDA.
 (FEBRUARY, 2010)

SHEET 10 OF 10

PLAT BOOK 113
 PAGE 101

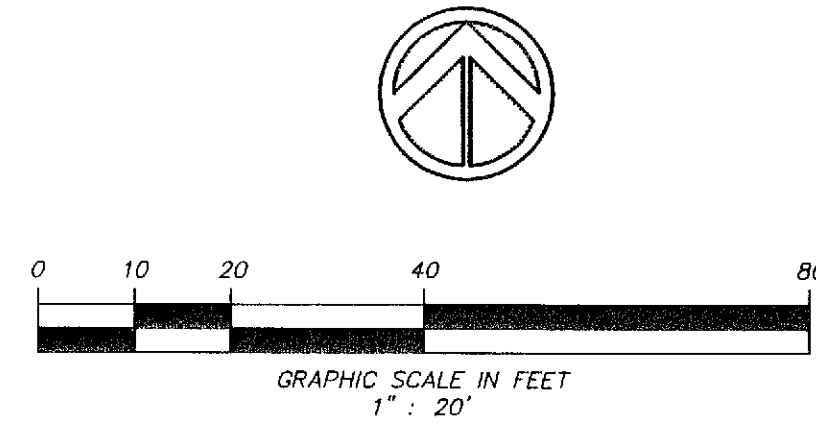

RECORD PLAT PREPARED BY:
SUN TECH Sun-Tech Engineering, Inc.
 Engineers - Planners - Surveyors
 Certificate of Authorization Number LB 7019
 1600 West Oakland Park Boulevard Ft. Lauderdale, FL 33311 Phone (954) 777-3123
 E-Mail: suntech@suntecheng.com Fax (954) 777-3114

STATE OF FLORIDA)
 COUNTY OF PALM BEACH) SS
 THIS PLAT WAS FILED FOR RECORD
 AT _____, THIS _____
 DAY OF _____, 201____, AND DULY
 RECORDED IN PLAT BOOK _____
 ON PAGES _____ THROUGH _____

 SHARON BOCK
 CLERK & COMPTROLLER
 BY: _____

EAST LINE N.W. 1/4
 SECTION 12-47-42

MATCH TO SHEET 9 OF 10

REMAINDER OF
 PARCEL 2
 BOCA TECHNOLOGY CENTER PLAT 1
 (P.B. 96, PGS. 178-181, P.B.C.R.)
 (NOT INCLUDED)
 OWNER: SHOPPES OF BLUE LAKE II
 PROPERTY CONTROL NO.
 06424712060020020

PARKING EASEMENT
 (O.R.B. 14869, PG. 1844)
 (O.R.B. 17082, PG. 1640)

905.21'

N77°02'48"E

MATCH TO BELOW

N77°02'48"E

TRACT N
 59,033 SQ.FT.

WEST TELECOM DRIVE

FD. NAIL & DISC
 #LB7219 (PRM)

514.92'

563.24' (TOTAL)

PARCEL 1
 BOCA TECHNOLOGY CENTER PLAT 1
 (P.B. 96, PGS. 178-181, P.B.C.R.)
 OWNER: BRE BOCA CORPORATE
 CENTER, LLC
 PROPERTY CONTROL NO.
 06424712060010010

N77°09'13"E

TRACT N
 59,033 SQ.FT.

LEGEND:

- P.B.C.R. = PALM BEACH COUNTY RECORDS
- O.R.B. = OFFICIAL RECORDS BOOK
- E = CENTERLINE
- P.R.M. = PERMANENT REFERENCE MONUMENT (AS NOTED)
- No. = NUMBER
- Pg. = PAGE
- P.B. = PLAT BOOK
- S.F. = SQUARE FEET
- LB = LICENSED BUSINESS
- R/W = RIGHT OF WAY
- F.D.O.T. = FLORIDA DEPARTMENT OF TRANSPORTATION
- O/S = OFFSET
- U.E. = UTILITY EASEMENT
- I.D. = IDENTIFICATION
- P.C. = POINT OF CURVATURE
- FD. = FOUND
- IP. = IRON PIPE
- I.R. = IRON ROD
- CB = CHORD BEARING
- C = CHORD DISTANCE
- R = RADIUS
- Δ = DELTA OR CENTRAL ANGLE
- L = ARC LENGTH
- PCP = PERMANENT CONTROL POINT

MATCH TO SHEET 9 OF 10

REMAINDER OF
 PARCEL 2
 BOCA TECHNOLOGY CENTER PLAT 1
 (P.B. 96, PGS. 178-181, P.B.C.R.)
 (NOT INCLUDED)
 OWNER: SHOPPES OF BLUE LAKE II
 PROPERTY CONTROL NO.
 06424712060020020

FD. NAIL & DISC
 #LB7019 (PRM)

N77°02'48"E

905.21'

N12°57'12"W
 65.38'

WEST TELECOM DRIVE

FD. NAIL & DISC
 #LB7219 (PRM)

TRACT N
 59,033 SQ.FT.

393.28'

PARKING EASEMENT
 (O.R.B. 15059, PG. 715),
 (O.R.B. 16047, PG. 667) &
 (O.R.B. 16047, PG. 648)

N77°02'48"E

MATCH TO ABOVE

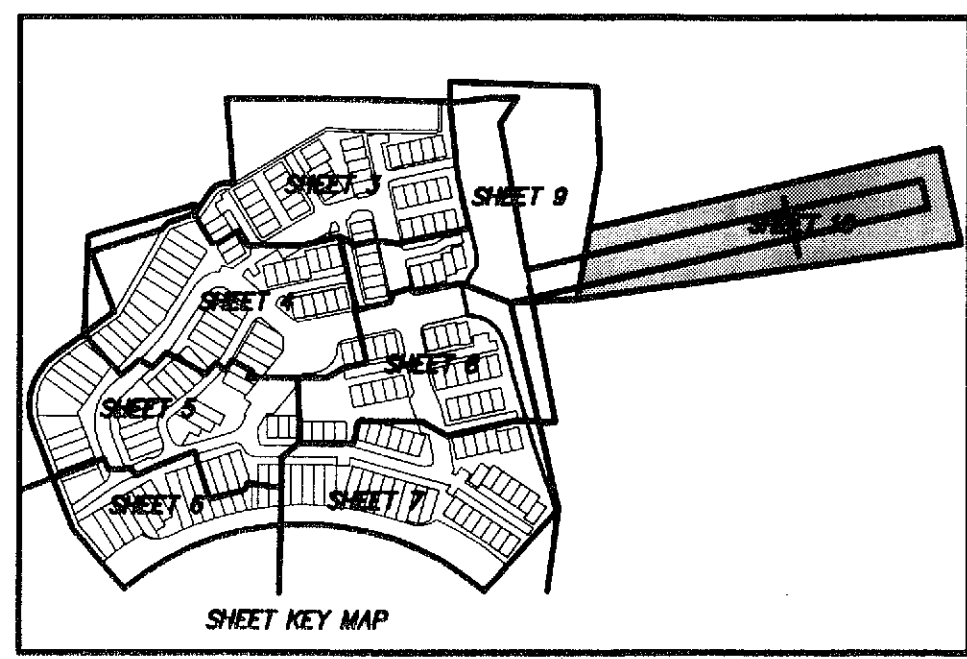

SHEET KEY MAP